

Fitting instructions
----------------------

Make:	Hyundai
-------	---------

	i20; 2008->
--	-------------

Type:	5082
-------	------

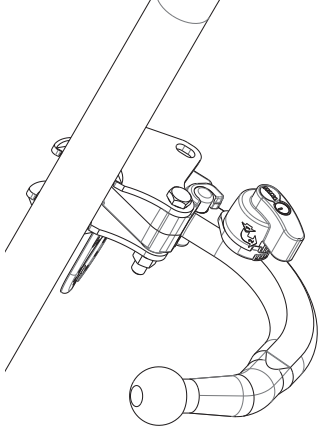

ser.nr:

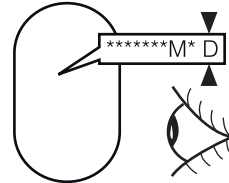

ser.nr:

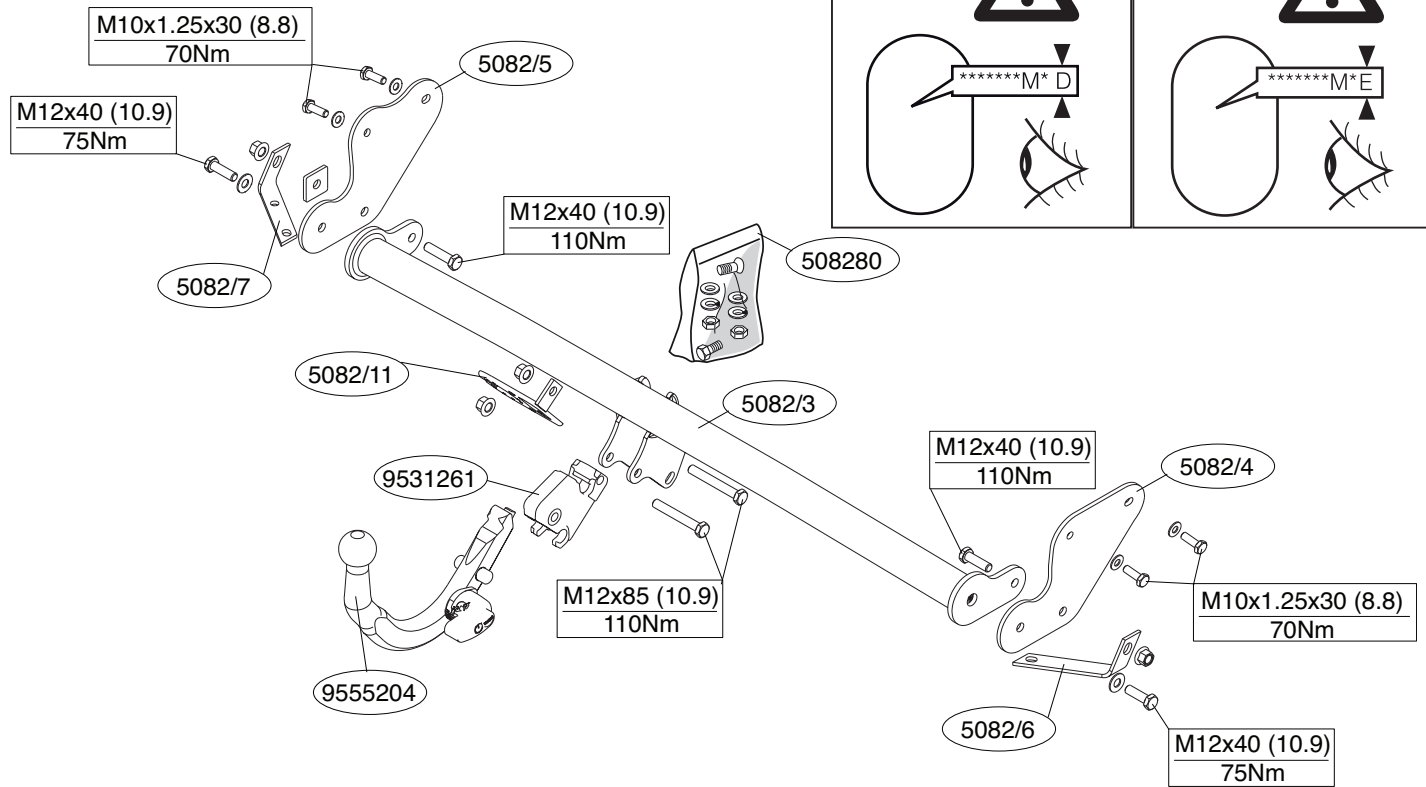
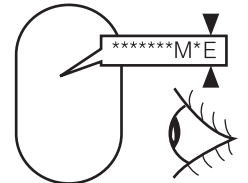

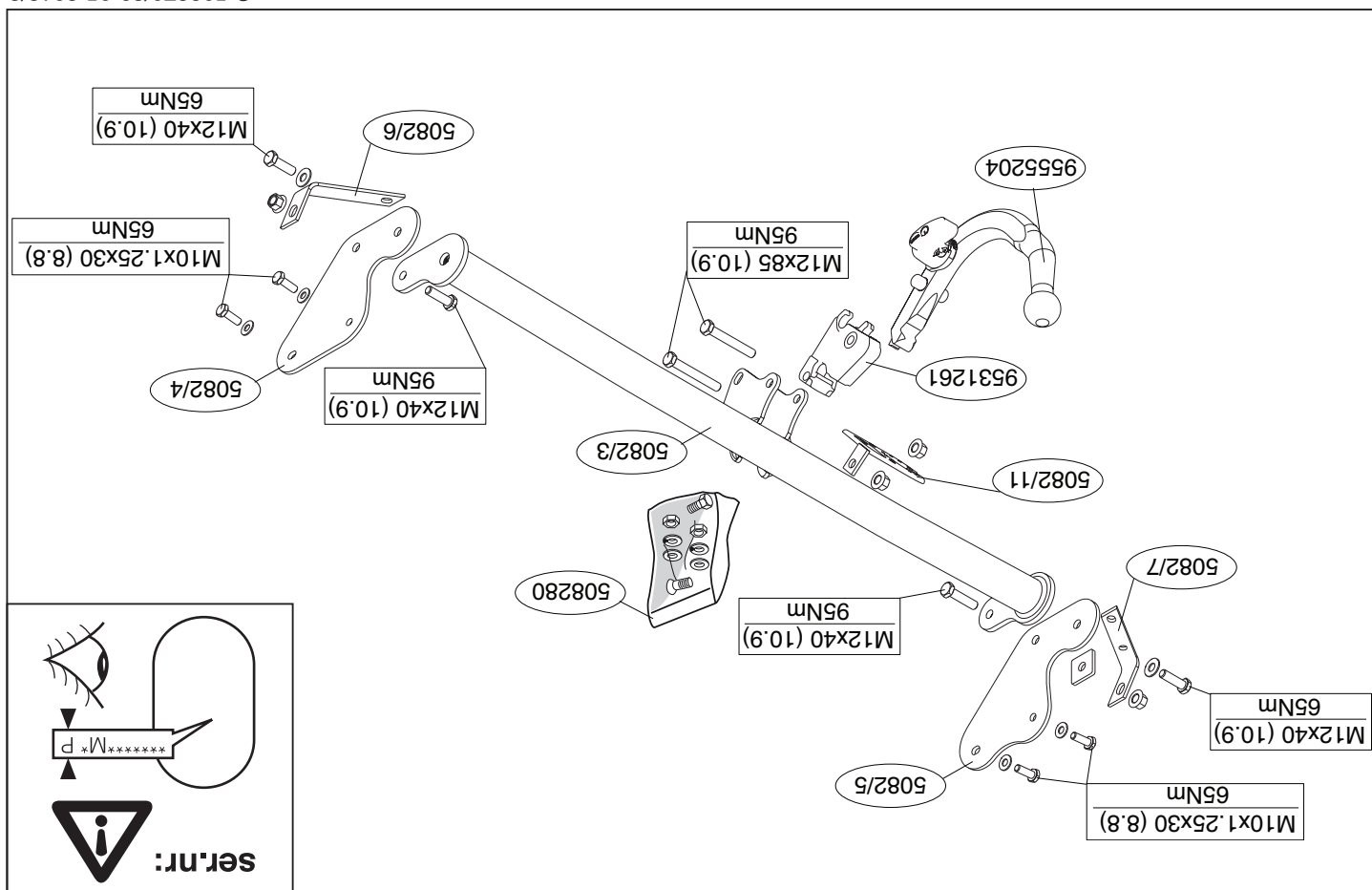

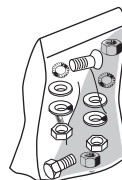
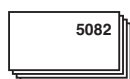
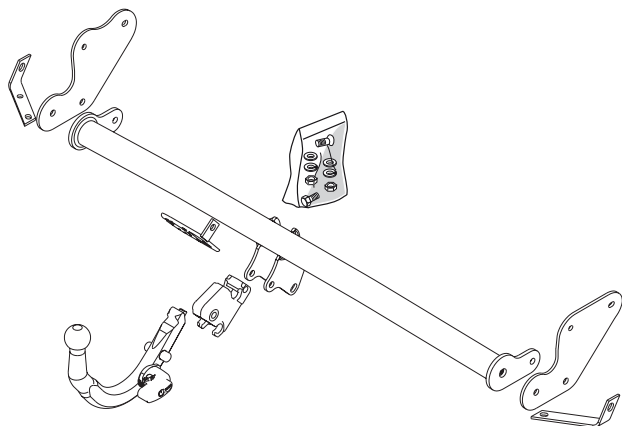
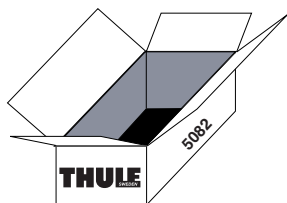

(2x) M12x85 (10.9)



(4x) M12



(4x) M12x50 (10.9)



(6x) M12



(4x) M12x1,25x40 (8.8)



(1x) 40x40x5

© 508270/29-05-2012/3

© 508270/29-05-2012/12



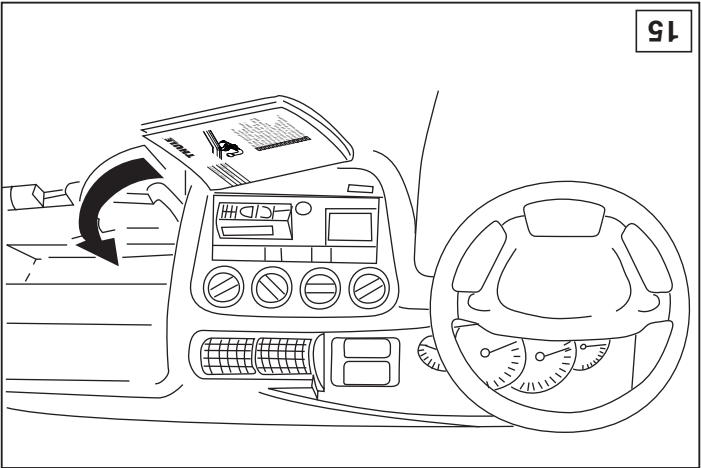
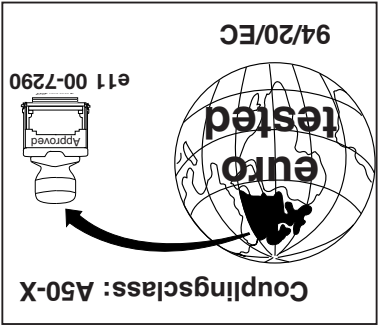
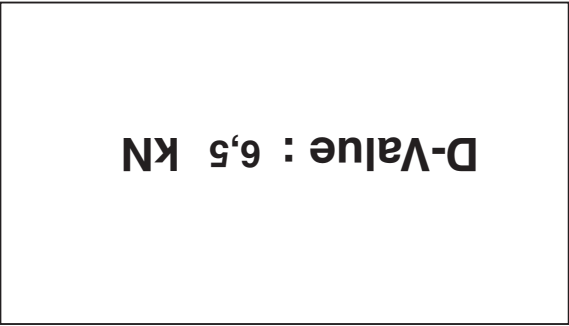
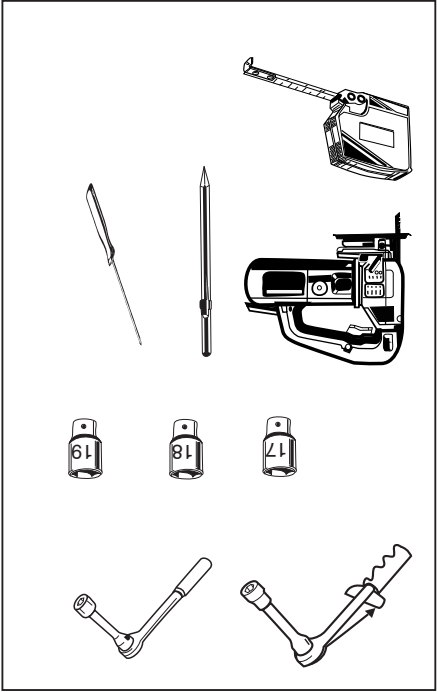
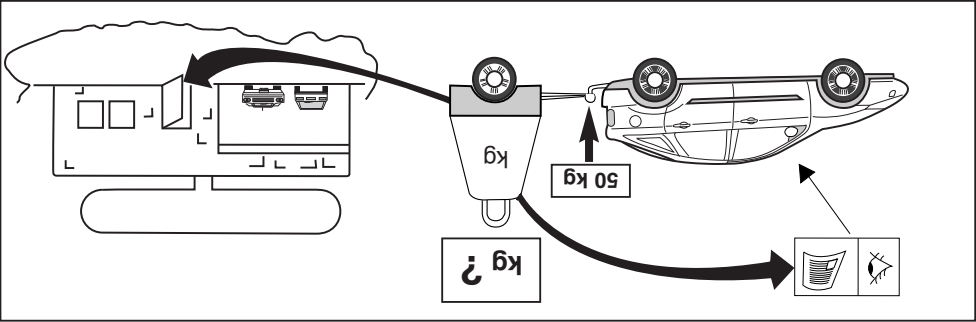
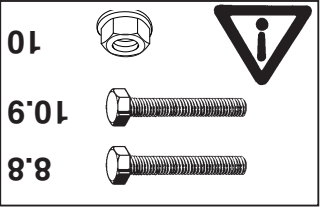
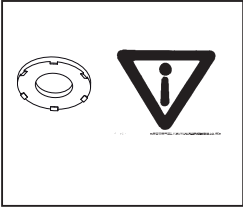
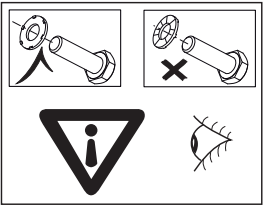
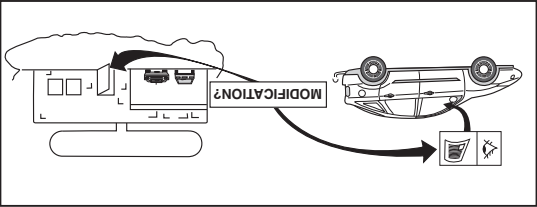



#### NOTE:

\* Should this installation process entail the cutting of the bumper – conformation **MUST** be obtained by the installation engineer of the customer's acceptance prior to completion. Thule Towing Systems do not accept responsibility for any matters arising as a result of this miscommunication.

**All measurements are in mm!**

#### HINWEISE:

\* Die für das Fahrzeug zugelassene Anhängelast ist den Fahrzeug Unterlagen zu entnehmen. Bei Änderungen des Fahrzeuggewichtes muß die höchstzulässige Anhängelast gegebenenfalls aus dem D-Wert nachgerechnet werden.

Auskunft hierüber kann Ihr Fachhändler oder der TÜV geben.

\* Elektrische Anlage gemäß StVZO anbringen.

© 508270/29-05-2012/5

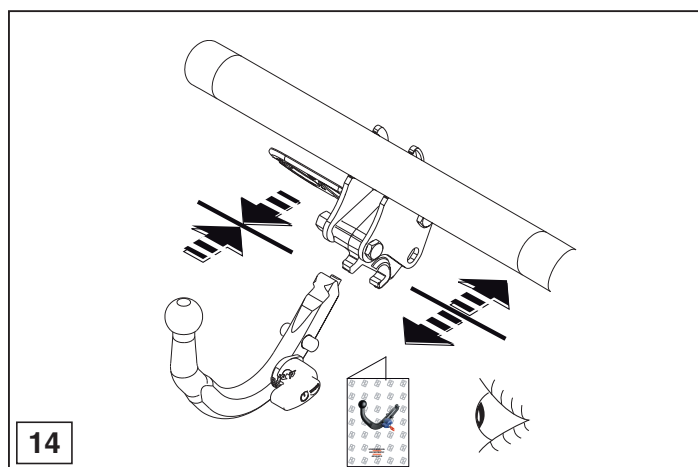
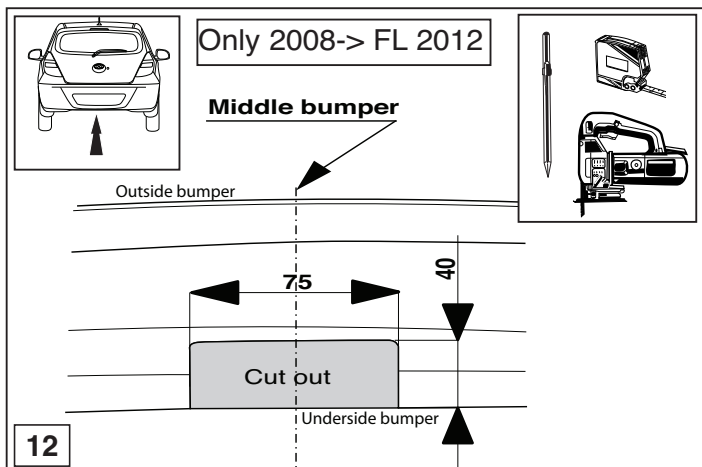
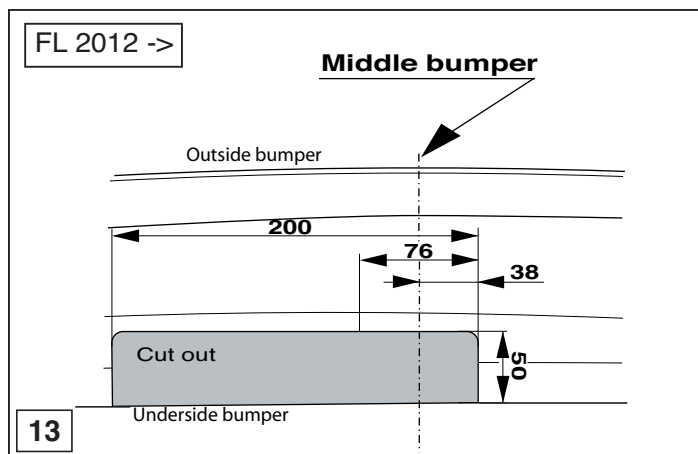
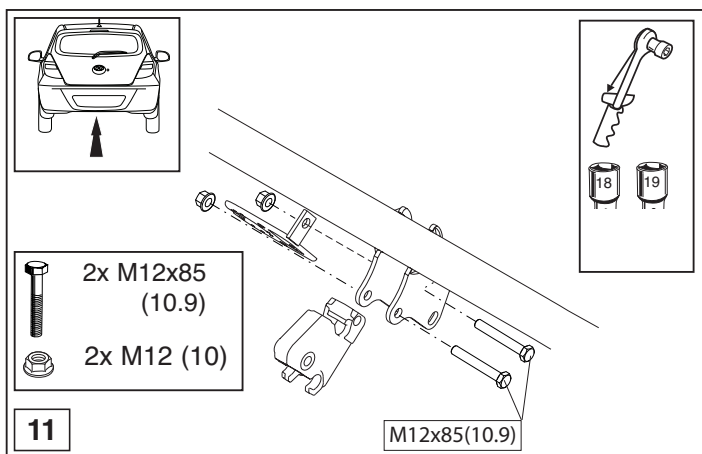

© 508270/29-05-2012/10

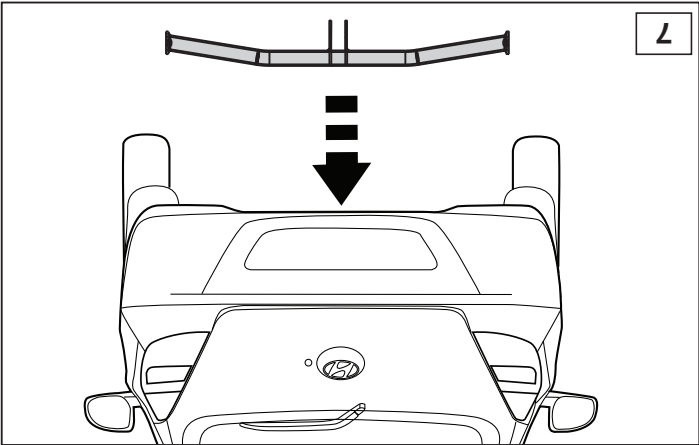
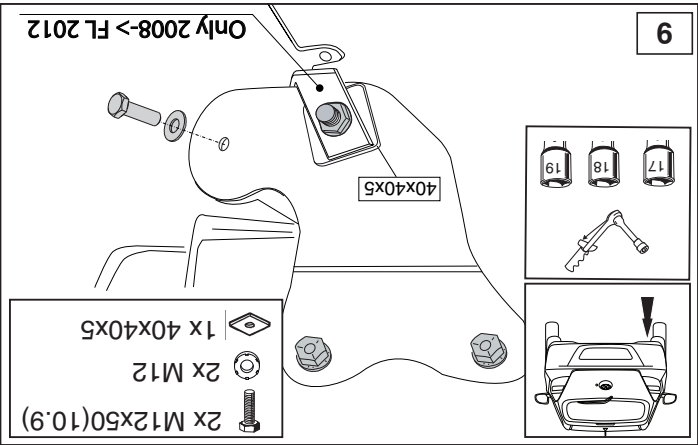
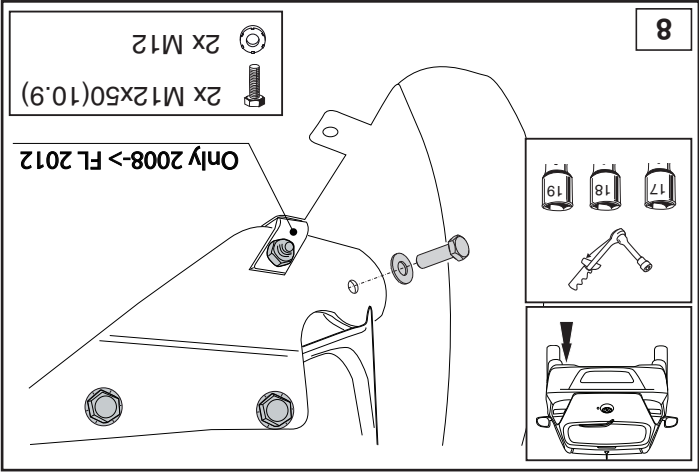
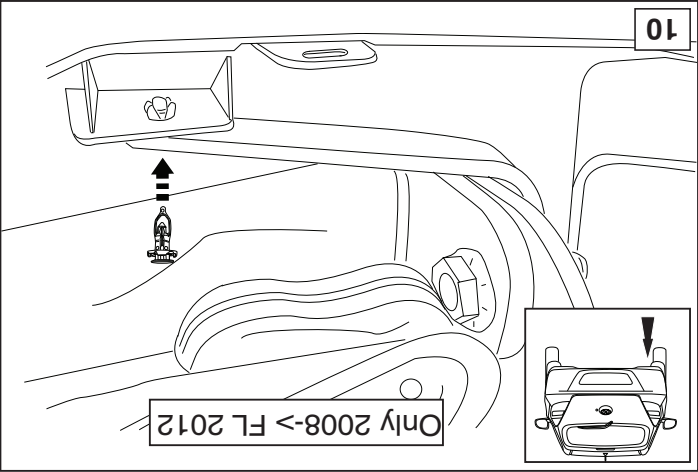
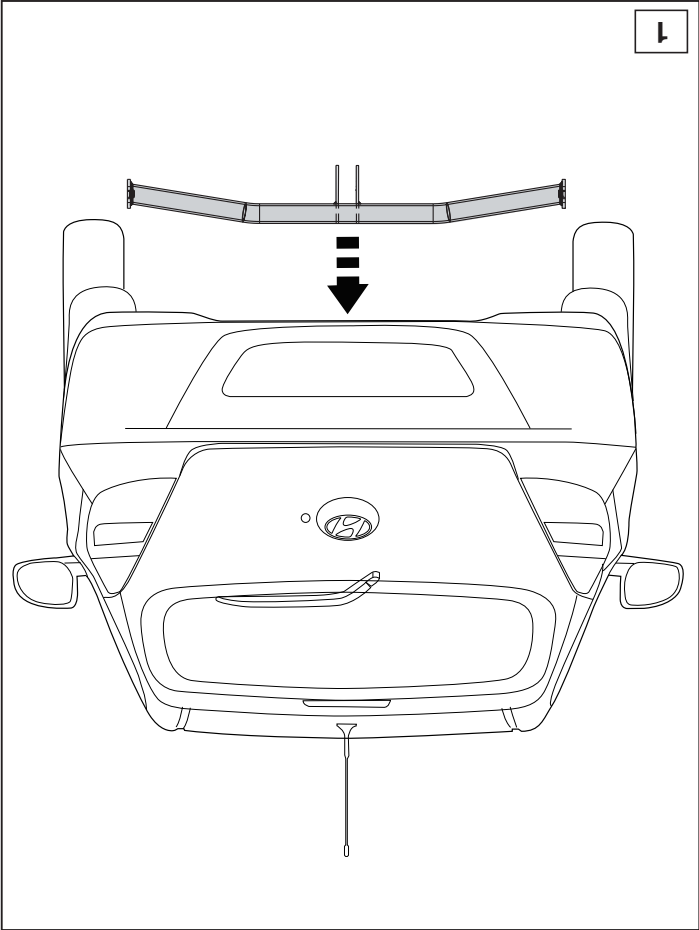
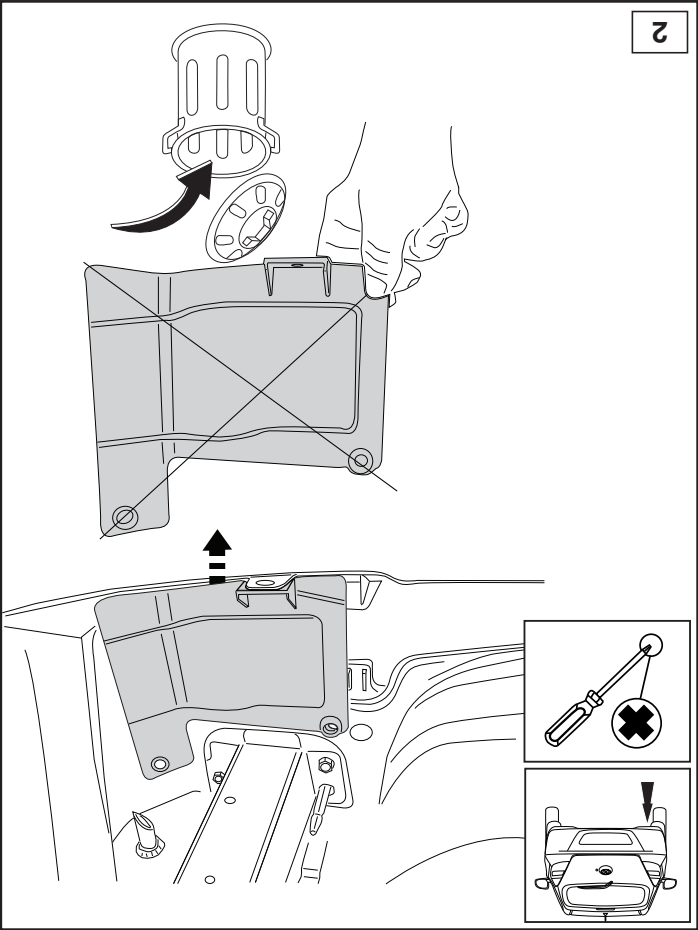

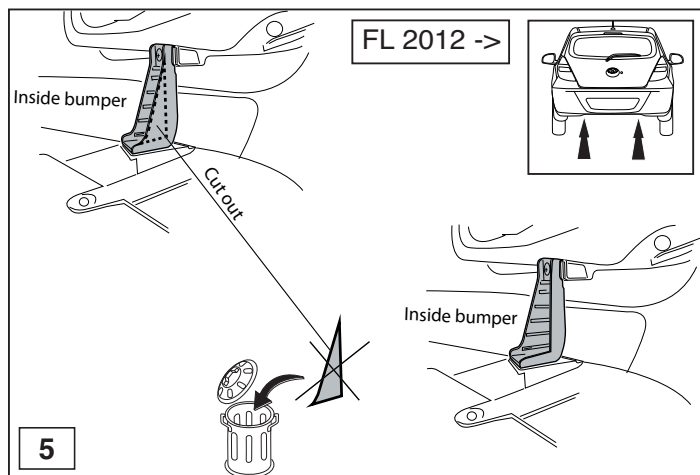
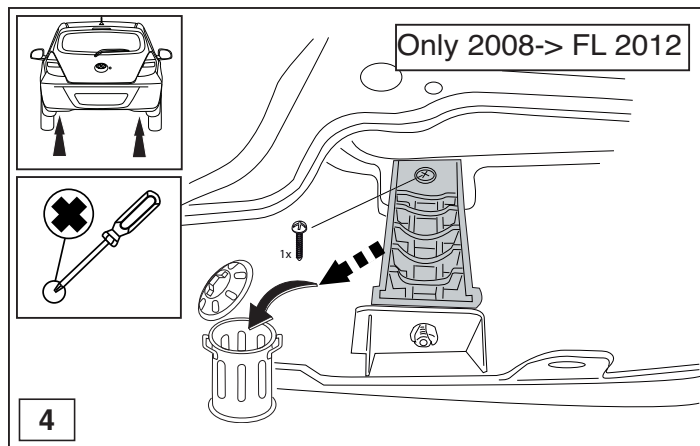
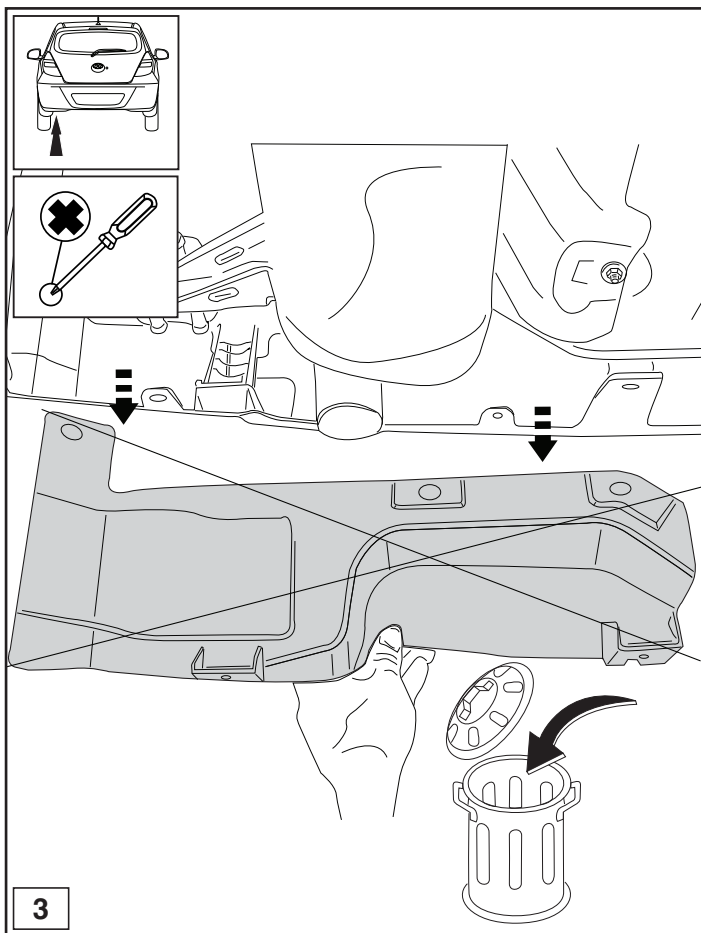

© 508270/29-05-2012/7

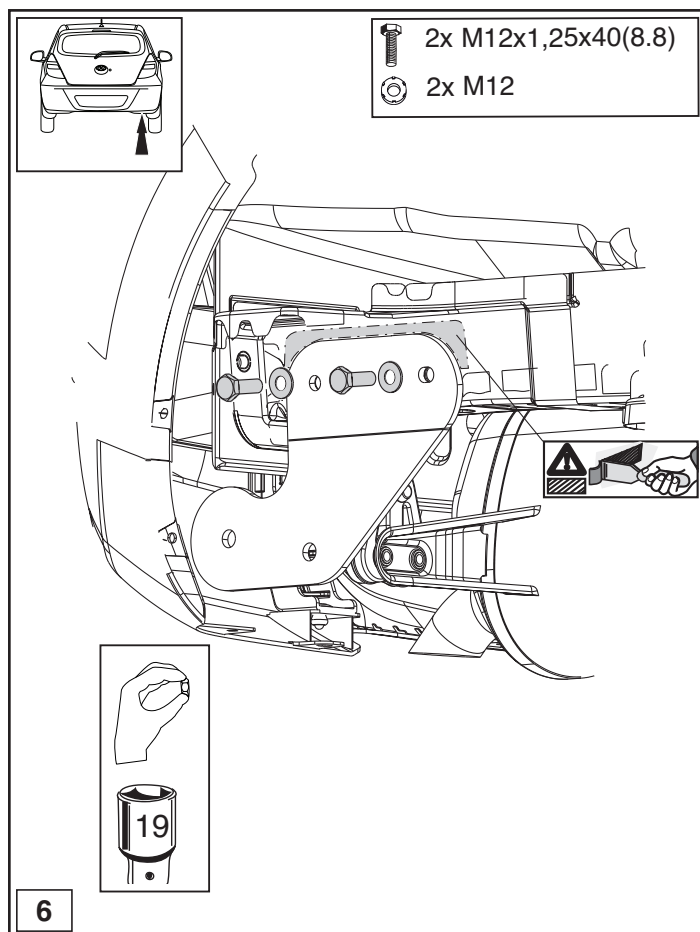
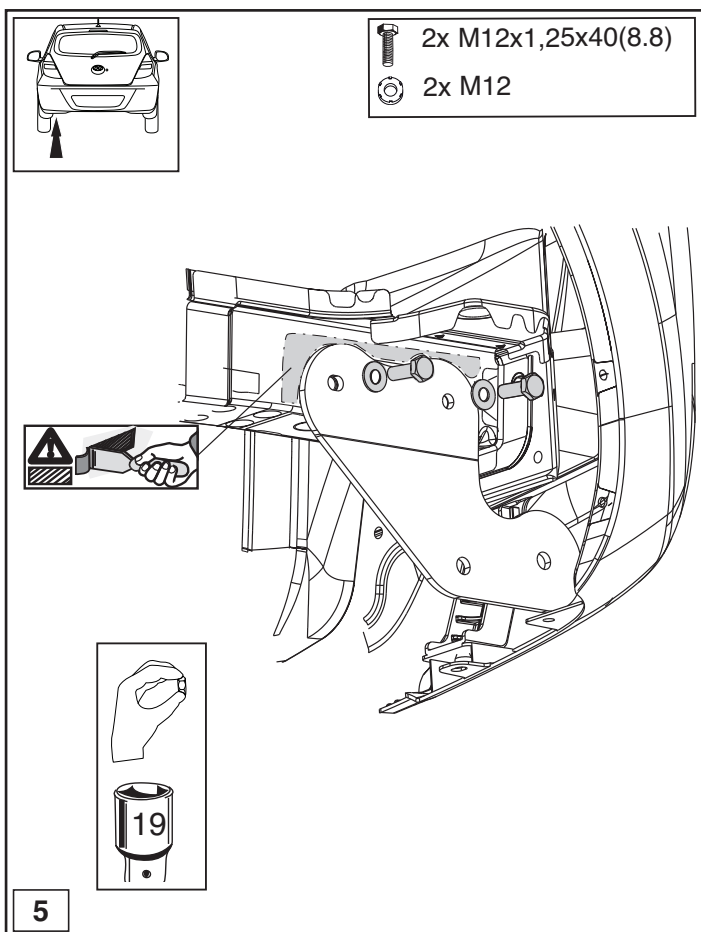

© 508270/29-05-2012/8