

# R1002012xx

Lv4-2020-r1

Modelo-model:

**FIRRAK onus R**

Lote-Lot-Lot-Lot:



Peso-Weight-Poids-Gewicht:



**Max. 50 kg**

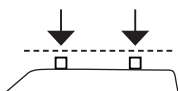

ES **Instrucción de montaje**  
¡Leer primero!

EN **Assembly instructions**  
Read first!

FR **Instruction de montage**  
Lire en premier!

DE **Montageanleitung**  
Zuerst lesen!

Barras de acero

Steel bars

Barres d'aluminium

Stahldachträger

1



x1



x1



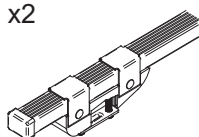

x2



x1

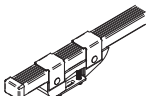

(810-000)

Código Code				Lote Lot
R100201201	(841-215)	115 cm	3,50 kg	01/20
R100201202	(841-225)	125 cm	3,79 kg	01/20



**Importante!**  
**Important!**  
**Important!**  
**Wichtig!**

ES Estas barras tienen que usarse con Kits de fijación FIRRAK!

EN Bars must be used with FIRRAK fixation Kits!

FR Les barres devront être utilisées avec les Kits de fixation FIRRAK!

DE Die Dachlasträger nur mit FIRRAK Stützfuß-Kits befestigen!

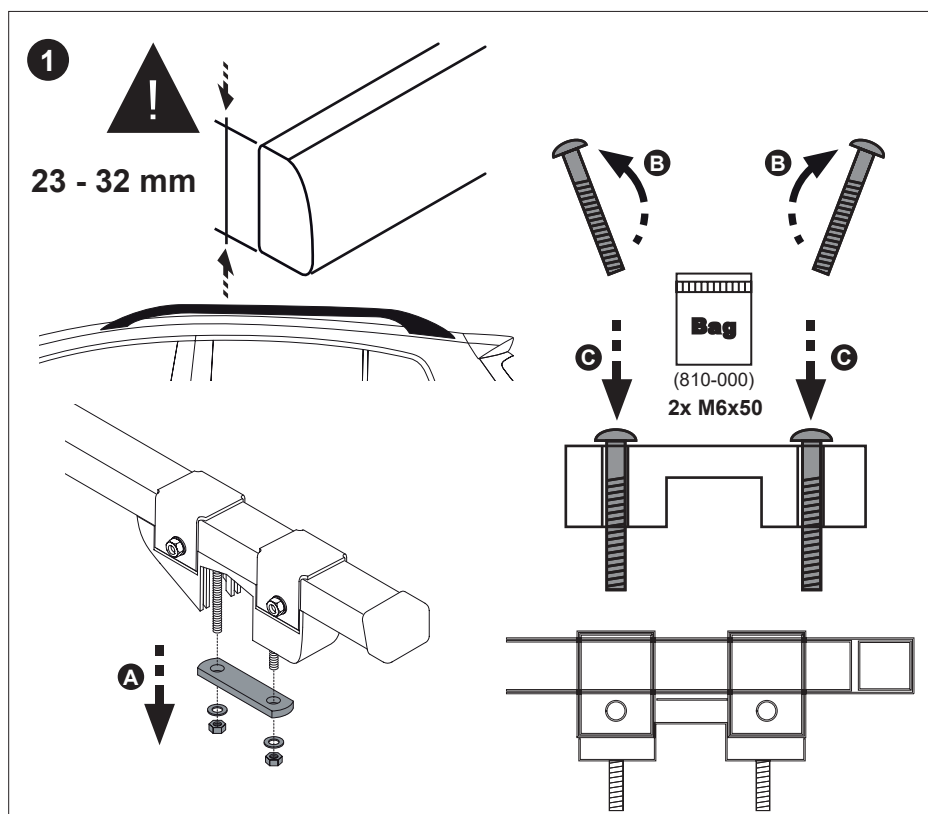
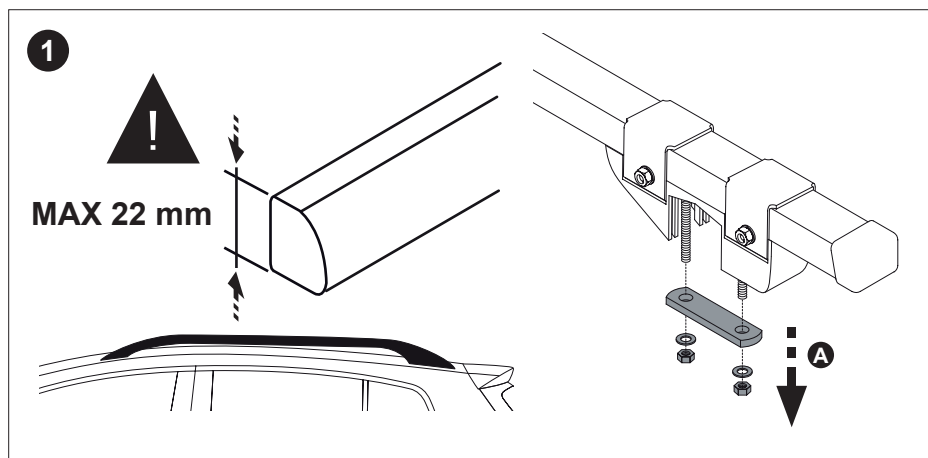



2

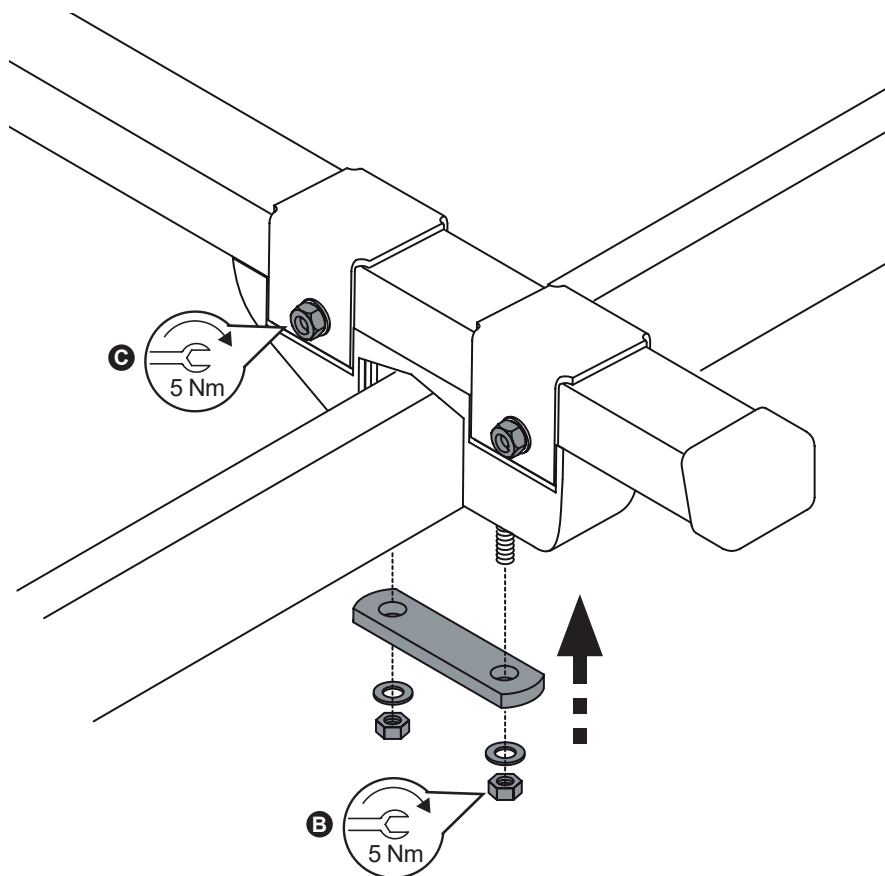
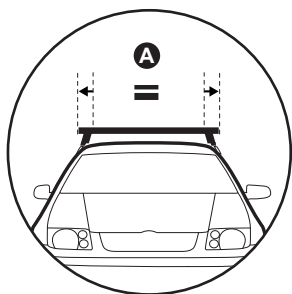









CRUZBER SA  
ES-A14018311  
Pol.Ind. Las Salinas II  
14960 - Rute - Spain

[www.firrak.eu](http://www.firrak.eu)